

DAHUA CCTV Playback Quick Guide

PLAYBACK Follow below steps :

1. Right click (Mouse provided) anywhere on the Monitor (CCTV Screen or TV) where the Recorder is connected to .
2. On the small window that pops up on the screen left click on “ Search “or“Video “ the PLAYBACK page will open up. If the system prompts you for a password it will pop up a Swipe Keypad (See picture here)

Click on “SWITCH USER “ on the right bottom and you will see a new window pop up where you can enter your password (See picture below)

Your Installer would have provided you with a Login password .
Enter your password using the on screen keyboard and click ENTER and OK

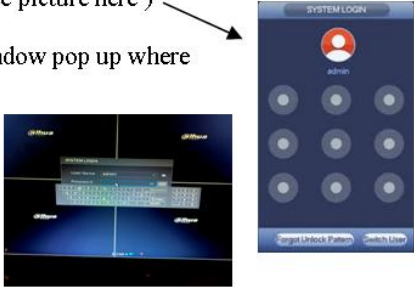

3. You are now in the PLAYBACK page . Select the date you like to playback from the calendar on the right top of the page .



4. Select the camera number you want to Playback (you can select more than one camera if you wish)

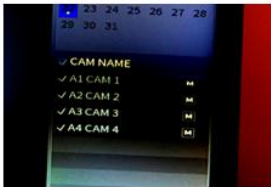

Late model DVR



Early model DVR

5. Go to the bottom of the page where the 24 hour time bar is and place the cursor on the time you like to playback
Now double click on the exact time that you want to playback, make sure you are in the coloured section of the time bar where there are recordings indicated by Green and/or Yellow colour .
You can use the Fast & Slow playback buttons above the time bar and you can skip recordings by double clicking on different times along the 24 hour time bar .

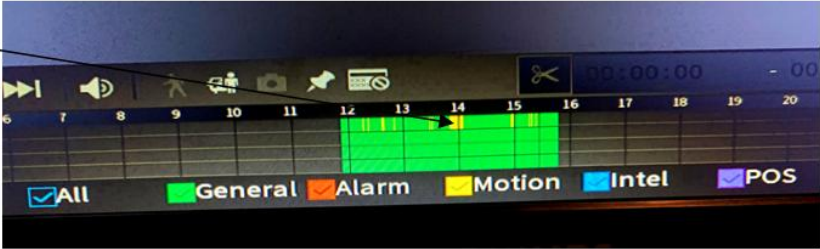

6. When you finish with Playback keep on right clicking slowly until you get back to LIVE screen, every time you right click from the Playback page it takes you one step back .